

ASTORIA DUPLEX

ASTORIA, NY

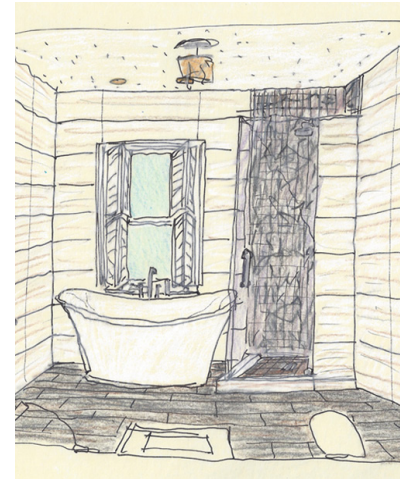

This two family rowhouse continues a traditional cohesive street facade found in the northern part of Astoria. The ground floor unit, with cellar, will have a complete renovation to upgrade the spacious open living and dining room areas as well as to create a larger master bedroom, new master bathroom and powder room. As the new owners both enjoy cooking, the kitchen was designed to be a focal point for entertaining as well as family time. The existing kitchen space will be opened up to provide an island for food preparation and socializing. The cellar will have a new stairway leading to a recreational space as well as a laundry room, exercise area and a full bathroom. On the exterior, new energy efficient windows and doors will be installed as well. The house will be frequently accessed from the rear, where the garage is located, so a new entry canopy will be installed at the cellar door to provide a more welcoming arrival point.

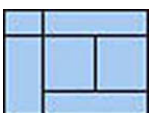
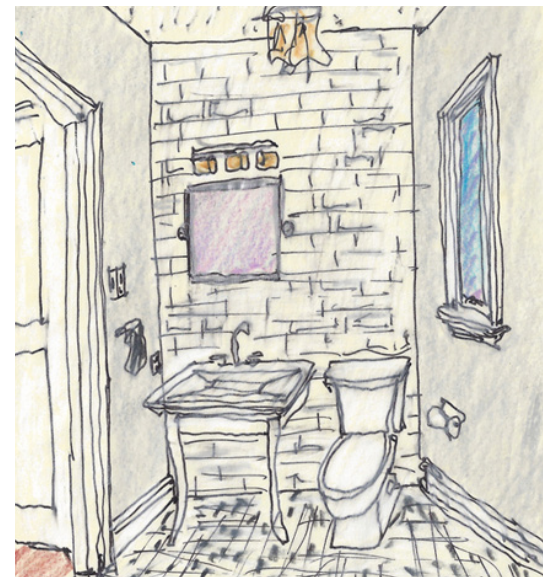

Laura Heim Architect PLLC
www.heimarchitect.com

Type: Residential Renovation
Program: Kitchen, Bathrooms, Cellar
Area: 2400SF
Status: Construction 2015